

Bottle Catalog 2026

Spiltag

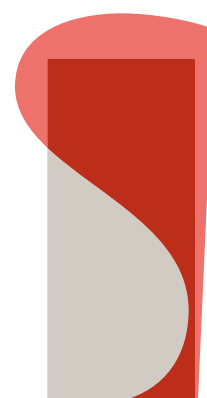



Discover the Spiltag USA difference in 7 key steps:

1**Prompt Response for Quotation**

- Fast and transparent quoting process to keep your projects moving efficiently. All you need to do is fill out our form with the technical specifications — it's that simple.

2**Complete In-House Decoration Capability**

- Everything under one roof: Silk Screen Printing, Hot Stamping, and Spray Painting. This guarantees exceptional quality control and quick turnaround times.

3**Flexible MOQ Options**

- Minimum Order Quantity (MOQ) of 50,000 units.
- Split orders for decoration starting at just 10,000 units, providing you with flexible production planning.

4**Warehousing Across the USA**

- Strategic warehouse locations throughout the U.S. to stock your production. Pay only for what you use—no upfront bulk payments required.

5**Prototyping, Decorated Samples, and Tech Drawings – At No Cost**

- Get prototypes and decorated samples at no charge, ensuring you see the final look before full-scale production. Our engineering support team is ready to bring any custom project to life.

6**You Are Buying from an American Company**

- Spiltag USA, established in 2023 in Miami. Enjoy the benefits of a smoother, more cost-effective supply chain with no tariffs, taxes, or bureaucracy.

7**The Best Lead Time in the Industry**

- 6–8 weeks for the first order (Considering our injection mold). We manage your stock to ensure just 3–5 days of local transit time from our U.S. warehouses.

About Us

Spiltag USA is supported by our manufacturing plant in Brazil, which boasts 30 years of market excellence serving global brands.

What We Do

We specialize in providing high-quality rigid packaging solutions for the cosmetic and beauty care industries.

Our Goal

We aim to build lasting partnership with distributors who share our dedication to quality, innovation, and customer satisfaction.

Our objective is to expand our presence in the American market by delivering exceptional packaging solutions that meet the evolving demands of the beauty and cosmetic sector.

A broad selection of colors



Clear



White



Black



Amber



Blue



Green

In Spiltag, you have many color options!

We offer over 6 standard colors available for selection, but if you want something even more exclusive, we have developed over 1000 custom colors for our clients. This way, you can choose the perfect color for your project.



Our high-performance Masterbatch portfolio



Closed Master

The standard closed Master has a glossy appearance and is ideal for highlighting vibrant colors in a unique way.



Color-Shift Master

The Color-Shift Master creates a dual-color effect, changing its apparent color depending on the angle and lighting conditions.



Frost Master

The Frost Master adds a matte finish while still allowing light to pass through and the product to remain visible.



Pearlescent Master

The Pearlescent Master gives a matte look without losing its shine, resulting in a modern and unique appearance.



Translucent Master

The standard Translucent Master retains its shine while allowing light transmission and product visibility.



Neon Master

Neon Master technology provides an intense glow effect in specific lighting conditions.



Glitter Master

The Glitter Master adds points of light (or sparkle/shimmer) which provide a special touch to the products



For the finish, combine with our **Matte Effect**

Gives the packaging a matte surface finish. Achieved by **uniformly applying matte varnish** to remove gloss.

Discover our decoration technologies



Screen Printing

Ink application using a squeegee to print images and/or text directly onto the bottle.



Varnish

Same technique as screen printing. Offers a variety of finishes and can add unique matte textures.



Halftone Screen Printing

Halftone technology allows for color variations and gradients with minimal ink application.



New

Four-Color Process

A printing technique that uses four base colors (cyan, magenta, yellow, and black) to create detailed images.



Hot Stamping

A thermal stamping process where a foil transfers an image onto the packaging, resulting in a sleek and luxurious appearance.



New

Sleeve

A heat-shrinkable wrapper (or shrink sleeve label) applied to the bottle, allowing its entire body to be covered with detailed image labeling.



New

Matte Hot Stamping

Hot stamping in which a ribbon (or foil) transfers the image to the packaging, creating a satin effect.



New

Embossing

Embossing can be applied via screen printing or molding, creating raised illustrations or effects on the packaging surface.



It's about Accessibility

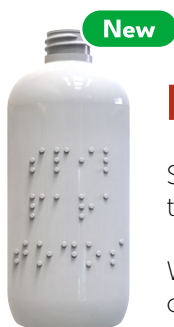

Braille

Spiltag believes everyone should have access to clear information about the products they use. That's why we're proud to present our inclusive Braille screen printing!

With our innovative Braille screen printing, every package becomes a milestone on the journey towards a more inclusive and accessible society

It's about Quality

Spiltag USA embodies flexibility and agility, and is ready to offer customized, efficient, and complete packaging solutions for projects of all sizes.

Fast & Reliable Tooling

Injection molds: 90–120 days from Korea — ensuring world-class precision and quality.

Blow molds: 30–45 days, locally supplied for speed and flexibility.

Backed by a dedicated technical team, we bring your custom projects to life with efficiency, innovation, and full support across the U.S. market.



ISO 9001

Spiltag holds ISO 9001 certification. This certification attests that the company follows rigorous quality standards in its production and commercialization. By adopting the Quality Management System (QMS) based on ISO 9001, Spiltag identifies inefficient processes, measures results, and ensures continuous improvement.

It's about Sustainability

Resin option
PCR-PET 10T



X

Resin option
PCR-PET 0T



All your products can have Resin PCR-PET

We offer a range of high-quality plastic resins derived from post-consumer recycled (PCR) materials, with options ranging from 25% to 100% PCR content.



ISO 14001

Spiltag is ISO 14001 certified, which demonstrates its commitment to protecting the environment. By following rigorous standards and offering sustainable solutions, Spiltag is helping to shape a better world for future generations.

Boston Round Bottles

1oz

30ml

Cap size: 20/410
Weight: 7g
Diameter (Width): 29.3mm
Height: 71.7mm
Decoration: 85mm x 39mm
Case QTY: 1170

250.0030.106

1.5oz

45ml

Cap size: 20/410
Weight: 7g
Diameter (Width): 35mm
Height: 72.1mm
Decoration: 105mm x 30mm
Case QTY: 775

250.0045.067

2oz

60ml

Cap size: 20/410
Weight: 10.8g
Diameter (Width): 38.5mm
Height: 81.3mm
Decoration: 112mm x 42mm
Case QTY: 580

300.0060.106



Shape: Round

Boston Round Bottles

3.4oz

100ml

Cap size: 20/410
Weight: 14g
Diameter (Width): 39.5mm
Height: 117.5mm
Decoration: 115mm x 75mm
Case QTY: 378

337.0100.002

4oz

120ml

Cap size: 24/415
Weight: 20g
Diameter (Width): 48mm
Height: 109,3mm
Decoration: 140.8mm x 54.7mm
Case QTY: 336

6oz

180ml

Cap size: 24/410
Weight: 20g
Diameter (Width): 54mm
Height: 118.6mm
Decoration: 159mm x 65mm
Case QTY: 196



Coming
Soon

Coming
Soon



Shape: Round

*Merely illustrative images

Boston Round Bottles

8oz

237ml

Cap size: 24/410
Weight: 24g
Diameter (Width): 57.1mm
Height: 135.2mm
Decoration: 168,5mm x 76mm
Case QTY: 154

10oz

300ml

Cap size: 28/410
Weight: 30g or 33g
Diameter (Width): 59.7mm
Height: 144.5mm
Decoration: 177mm x 78mm
Case QTY: 122

12oz

355ml

Cap size: 28/410
Weight: 30g or 33g
Diameter (Width): 62mm
Height: 152.6mm
Decoration: 185mm x 87mm
Case QTY: 104



Shape: Round

Boston Round Bottles

13.5oz

400ml

Cap size: 28/410
Weight: 33g
Diameter (Width): 62mm
Height: 171.8mm
Decoration: 151mm x 117mm
Case QTY: 94

314.0400.121

16oz

473ml

Cap size: 28/410
Weight: 33g
Diameter (Width): 69,6mm
Height: 165mm
Decoration: 210mm x 105mm
Case QTY: 84

314.0500.122



Shape: Round

*Merely illustrative images

Bullet Bottles

1oz

30ml

Cap size: 20/410
Weight: 7g
Diameter (Width): 27mm
Height: 85mm
Decoration: 73mm x 50mm
Case QTY: 1134

250.0030.002

2oz

60ml

Cap size: 20/410
Weight: 10g
Diameter (Width): 31.6mm
Height: 105.5mm
Decoration: 90mm x 64mm
Case QTY: 631

300.0060.002

4oz

118ml

Cap size: 20/410
Weight: 14g
Diameter (Width): 41.4mm
Height: 124.4mm
Decoration: 121mm x 80mm
Case QTY: 338

337.0120.002



Shape: Round

Bullet Bottles

6oz

177ml

Cap size: 24/410
Weight: 20g or 24g
Diameter (Width): 44.5mm
Height: 151.6mm
Decoration: 130mm x 109mm
Case QTY: 214

8oz

237ml

Cap size: 24/410
Weight: 24g 
Diameter (Width): 48.8mm
Height: 166.5mm
Decoration: 145mm x 115mm
Case QTY: 180

338.0240.002

10oz

300ml

Cap size: 28/410
Weight: 33g
Diameter (Width): 54mm
Height: 170mm
Decoration: 160mm x 122mm
Case QTY: 114

314.0300.106



Coming
Soon



Shape: Round

Bullet Bottles

12oz

354ml

Cap size: 28/410
Weight: 30g or 33g
Diameter (Width): 55mm
Height: 189mm
Decoration: 162mm x 127mm
Case QTY: 119

16oz

473ml

Cap size: 28/410
Weight: 33g
Diameter (Width): 61.9mm
Height: 193.2mm
Decoration: 183mm x 150mm
Case QTY: 90

314.0500.106



Coming
Soon



Shape: Round

Modern Round Bottles

16oz

473ml

Cap size: 28/410
Weight: 33g
Diameter (Width): 74mm
Height: 154.5mm
Decoration: 225mm x 80mm
Case QTY: 66

314.0500.021

33oz

975ml

Cap size: 28/410
Weight: 45g
Diameter (Width): 94mm
Height: 208.5mm
Decoration: 283mm x 120mm
Case QTY: 30

312.1000.021



Shape: Round

*Merely illustrative images

Thin Cylinder Bottles

0.5oz

15ml

Cap size: 18/415
Weight: 5.5g
Diameter (Width): 20.5mm
Height: 71mm
Decoration: 55mm x 40mm
Case QTY: 2340

140.0015.033

1oz

30ml

Cap size: 18/415
Weight: 9g
Diameter (Width): 20.4mm
Height: 126mm
Decoration: 55mm x 95mm
Case QTY: 1260

160.0030.033



Shape: Round

Cylinder Bottles

1oz

30ml

Cap size: 20/410
Weight: 7g
Diameter (Width): 29mm
Height: 73,9mm
Decoration: 86mm x 47mm
Case QTY: 1170

250.0030.180

2oz

60ml

Cap size: 20/410
Weight: 10.8g
Diameter (Width): 31.6mm
Height: 106.2mm
Decoration: 92mm x 71mm
Case QTY: 629

300.0060.065

4oz

120ml

Cap size: 20/410
Weight: 15g
Diameter (Width): 40mm
Height: 134,9mm
Decoration: 121mm x 102mm
Case QTY: 272

345.0120.180



Shape: Round

Cylinder Bottles

8oz

237ml

Cap size: 24/410

Weight: 24g **FW**

Diameter (Width): 49,5mm

Height: 168.6mm

Decoration: 145,5mm x 133mm

Case QTY: 165

8.5oz

260ml

Cap size: 24/410

Weight: 24g

Diameter (Width): 54mm

Height: 143.1mm

Decoration: 165mm x 105mm

Case QTY: 138

338.0260.118



Coming
Soon



Shape: Round

Cylinder Bottles

10oz

300ml

Cap size: 28/410
Weight: 30g or 33g
Diameter (Width): 53mm
Height: 174mm
Decoration: 156mm x 133mm
Case QTY: 148

12oz

354ml

Cap size: 28/410
Weight: 30g or 33g
Diameter (Width): 56.5mm
Height: 175mm
Decoration: 167mm x 130mm
Case QTY: 114

16oz

473ml

Cap size: 28/410
Weight: 33g
Diameter (Width): 63.2mm
Height: 200mm
Decoration: 185mm x 160mm
Case QTY: 81

314.0500.118



Coming
Soon

Coming
Soon



Shape: Round

*Merely illustrative images

Cylinder Bottle + Cap

Straight Cap

with plastic orifice reducer

This model come with
a straight 24/410 cap.

425.002

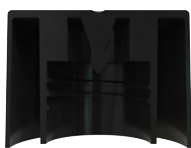

Inside of the Cap



7oz

200ml

Cap size: 24/410
Weight: 20g
Diameter (Width): 43.8mm
Height: 167.6mm
Decoration: 130mm x 130mm
Case QTY: 200

339.0200.154



Shape: Round

Cylinder Bottle + Overcap

PET Overcap

This model come with a straight 24/410 PET overcap.

Case QTY: 900

425.005



Inside of the Overcap

5oz

150ml

Cap size: 24/410
Weight: 24g
Diameter (Width): 39mm
Height: 165,2mm
Decoration: 115mm x 135mm
Case QTY: 278

338.0150.171



Shape: Round

Square Bottle Model 1



Shape: Square

Square Bottle Model 2

2oz

60ml

Cap size: 20/410
Weight: 10.8g
Diameter (Width): 34.5mm
Height: 110.8mm
Decoration: 20mm x 80mm
Case QTY: 583

300.0060.007

12oz

354ml

Cap size: 28/410
Weight: 33g
Diameter (Width): 65mm
Height: 192mm
Decoration: 45mm x 143mm
Case QTY: 105

314.0350.007



Shape: Square

Square Bottle Model 2

16oz

473ml

Cap size: 28/410
Weight: 33g
Diameter (Width): 68.4mm
Height: 204.7mm
Decoration: 50mm x 160mm
Case QTY: 66

314.0500.007

33oz

975ml

Cap size: 28/410
Weight: 45g
Diameter (Width): 86mm
Height: 253mm
Decoration: 52mm x 195mm
Case QTY: 30

312.1000.007



Shape: Square

Classic Oval Bottles

1oz

30ml

Cap size: 20/410
Weight: 7g
Diameter (Width): 37mm
Height: 75mm
Decoration: 27mm x 43mm
Case QTY: 1015

250.0030.001

2oz

60ml

Cap size: 20/410
Weight: 8g or 10.8g
Diameter (Width): 41.8mm
Height: 97.5mm
Decoration: 30mm x 60mm
Case QTY: 546

150.0060.001 (8g)
300.0060.001 (10.8g)

3.5oz

100ml

Cap size: 20/410
Weight: 12g
Diameter (Width): 48,9mm
Height: 112,3mm
Decoration: 30mm x 70mm
Case QTY: 345

305.0100.001



Shape: Oval

Classic Oval Bottles

4.5oz

140ml

Cap size: 24/410
Weight: 20g
Diameter (Width): 54.8mm
Height: 136.9mm
Decoration: 40mm x 95mm
Case QTY: 258

339.0140.001

7oz

200ml

Cap size: 24/410
Weight: 20g or 24g
Diameter (Width): 60.5mm
Height: 143.1mm
Decoration: 25mm x 100mm
Case QTY: 186

339.0200.001 (20g)
338.0200.001 (24g)

8oz

240ml

Cap size: 24/410
Weight: 24g
Diameter (Width): 67mm
Height: 160.3mm
Decoration: 48mm x 105mm
Case QTY: 136

338.0240.001



Shape: Oval

*Merely illustrative images

Modern Oval Bottles

1oz

30ml

Cap size: 20/410
Weight: 7g
Diameter (Width): 33.9mm
Height: 93.5mm
Decoration: 22mm x 63mm
Case QTY: 1020

250.0030.003

2oz

60ml

Cap size: 20/410
Weight: 10g
Diameter (Width): 40.1mm
Height: 110mm
Decoration: 25mm x 75mm
Case QTY: 563

300.0060.003

3.5oz

100ml

Cap size: 20/410
Weight: 12g or 14g
Diameter (Width): 46.9mm
Height: 133.8mm
Decoration: 30mm x 95mm
Case QTY: 356

328.0100.003 (12g)
337.0100.003 (14g)



Shape: Oval

*Merely illustrative images

Modern Oval Bottles

33oz

975ml

Cap size: 28/410

Weight: 46g or 60g

Diameter (Width): 103mm

Height: 257mm

Decoration: 60mm x 200mm

Case QTY: 28

324.1000.003 (46g)

321.1000.003 (60g)



Shape: Oval

*Merely illustrative images

Oval Bottle Model 1

3.5oz

100ml

Cap size: 20/410
Weight: 10.8g
Diameter (Width): 51.1mm
Height: 105.1mm
Decoration: 40mm x 65mm
Case QTY: 360

300.0100.018



Shape: Oval

Oval Bottle Model 2

3.5oz

100ml

Cap size: 20/410
Weight: 10.8g
Diameter (Width): 56mm
Height: 100.5mm
Decoration: 30mm x 50mm
Case QTY: 298

300.0100.004



Shape: Oval

Round Bottle Model 1

2oz

60ml

Cap size: 20/410
Weight: 7g or 10.8g
Diameter (Width): 44mm
Height: 87.8mm
Decoration: 28mm x 40mm
Case QTY: 552

250.0060.005 (7g)
300.0060.005 (10.8g)

3.5oz

100ml

Cap size: 20/410
Weight: 10g
Diameter (Width): 51mm
Height: 99.4mm
Decoration: 35mm x 58mm
Case QTY: 331

300.0100.005



Shape: Round

Round Bottle Model 2

2.5oz

80ml

Cap size: 20/410

Weight: 10.8g

Diameter (Width): 41.5mm

Height: 106.5mm

Decoration: 121mm x 30mm

Case QTY: 362

300.0080.019



Shape: Round

Round Bottle Model 3

2oz

60ml

Cap size: 20/410
Weight: 10.8g
Diameter (Width): 34.8mm
Height: 105mm
Decoration: 88mm x 72mm
Case QTY: 507

300.0060.057

7oz

200ml

Cap size: 24/410
Weight: 28g
Diameter (Width): 50.4mm
Height: 158.5mm
Decoration: 135mm x 110mm
Case QTY: 168

343.0200.057



Shape: Round

Sprayer Bottle

16oz

473ml

Cap size: 28/410

Weight: 33g

Diameter (Width): 80mm

Height: 214.5mm

Decoration: 45mm x 90mm

Case QTY: 60

314.0500.034



Shape: Oval

Spiltag USA Corporation
201 S Biscayne Blvd STE 1200
Miami, FL 33131, USA



+1 954 910 7638



[Spiltag.com](https://spiltag.com)